

San Francisco Recreation & Parks Department Market Octavia Plan CAC

Monday, May 15, 2017



Inspire, Connect, Play!

RPD Parks in and around Market Octavia

Buchanan St Mall



Hayes Valley Playground



Page Street Community Garden



Koshland Park



Duboce Park/
Harvey Milk Center

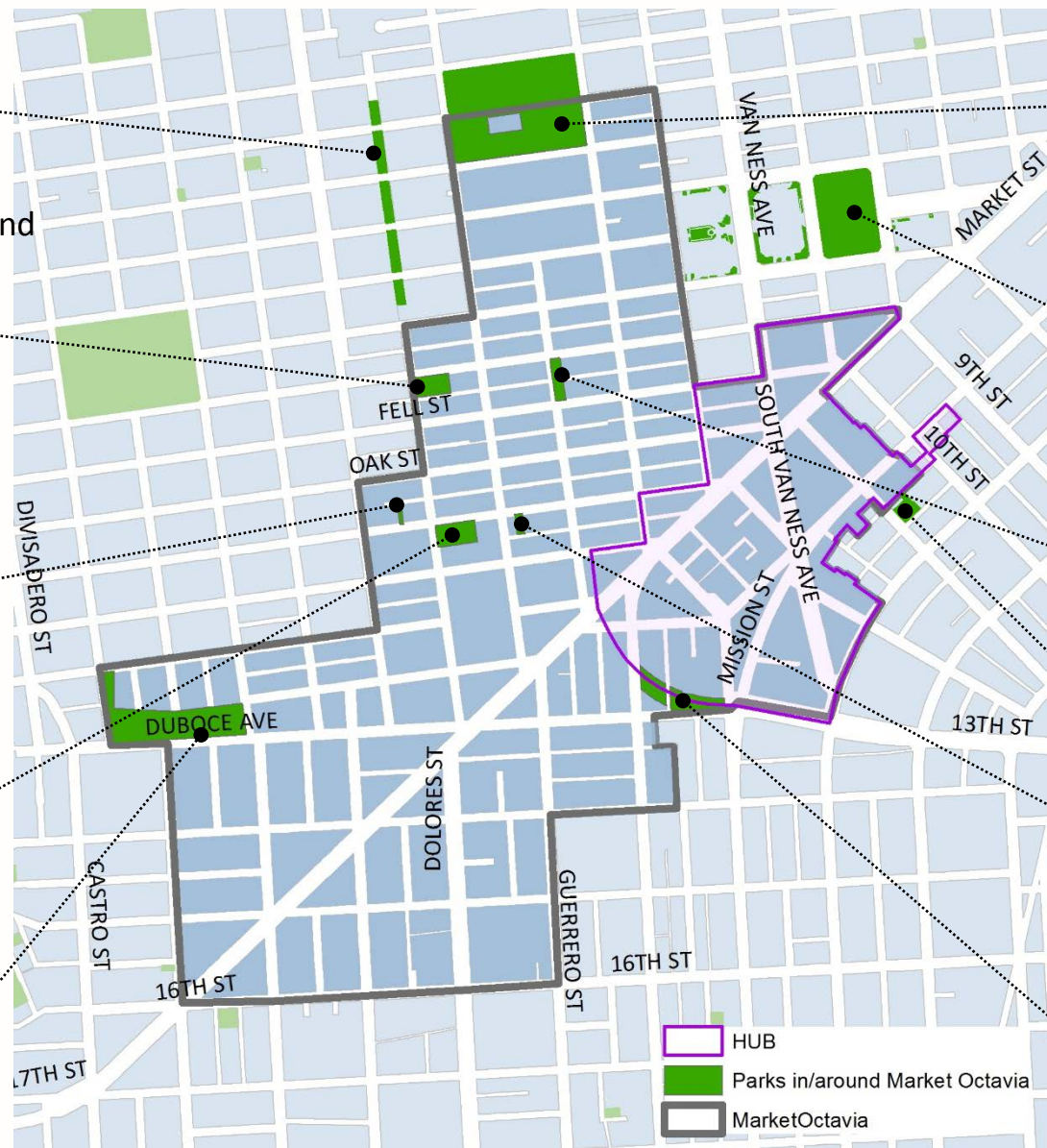

Margaret Hayward



Civic Center Plaza



Patricia's Green



11th & Natoma (acquisition)

Page & Laguna Mini Park



SoMa West



Existing Conditions

Buchanan St. Mall



Visioning

Buchanan St. Mall

Workshop 1



Workshop 2



Workshop 3



Reflection 1



Reflection 2



Additional Outreach





Community Planning for Activation



Installations



VISION FOR ALL FIVE BLOCKS

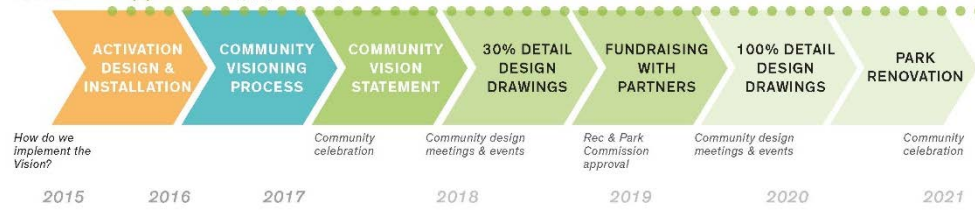

How do we implement the Vision?



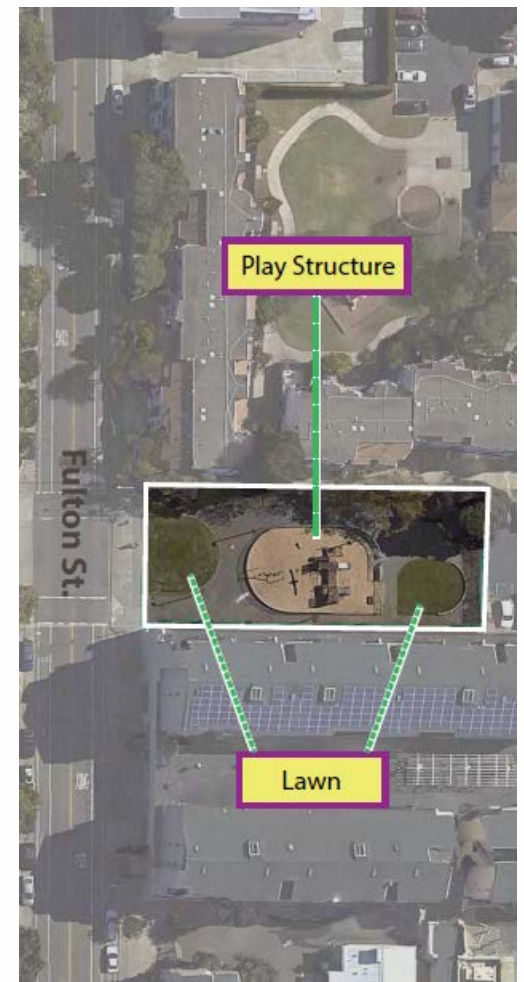
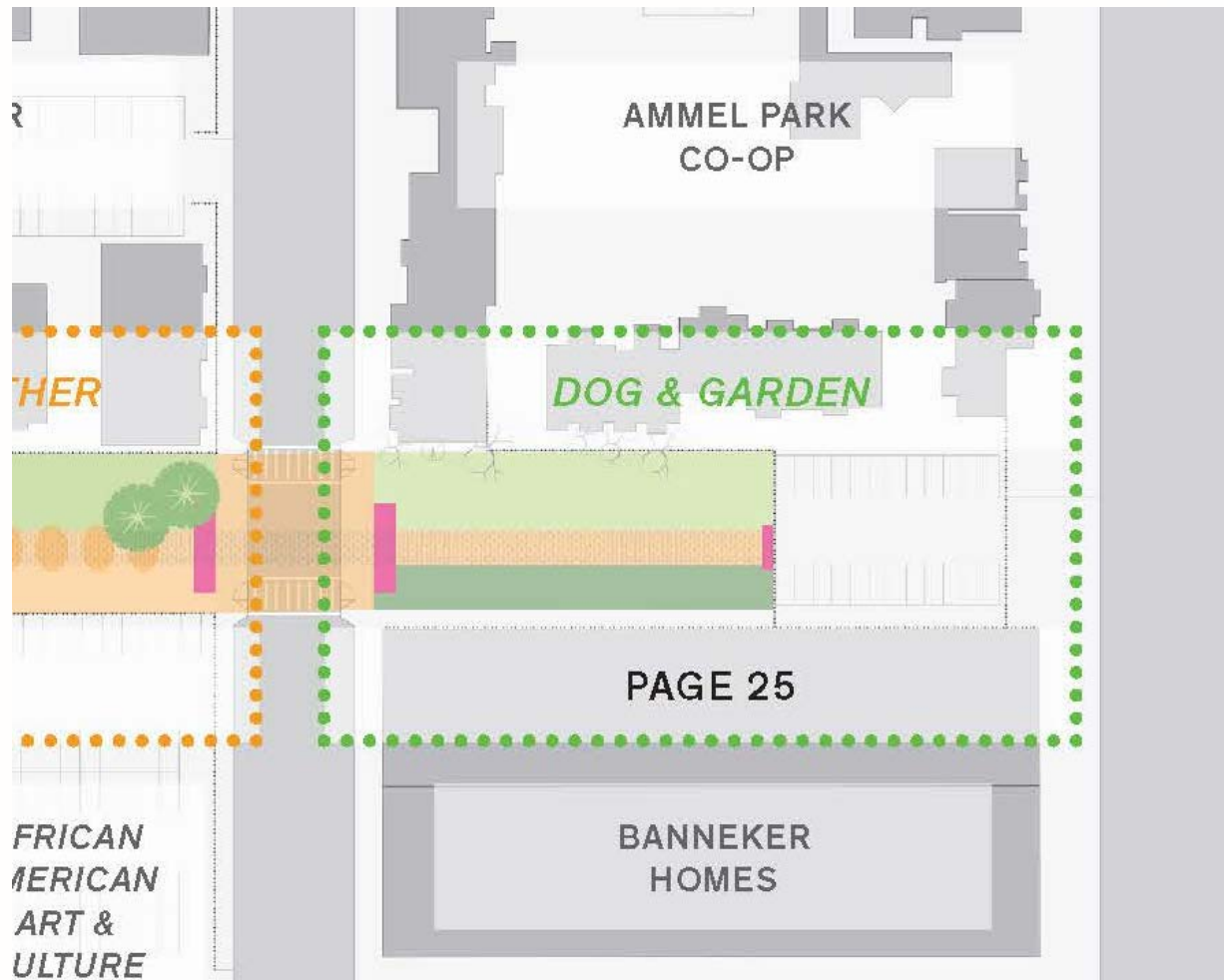

Existing Conditions

Civic Center Plaza



New South Playground

Civic Center Plaza



New North Playground

Civic Center Plaza



CREATING ONE COORDINATED PLAN ACROSS AGENCIES



Civic Center Playground Renovation

Rec. & Park Department



Central Market/Tenderloin Strategy

Office of Economic and Workforce Development & the Planning Department

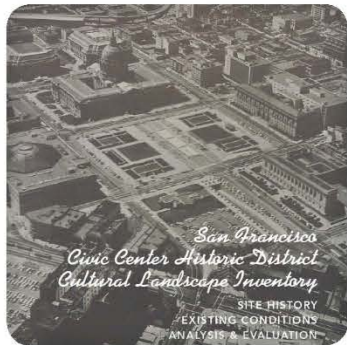

San Francisco Civic Center Historic District Cultural Landscape Inventory

Planning Department



"Market Street Hub" Plan Revision

Planning Department

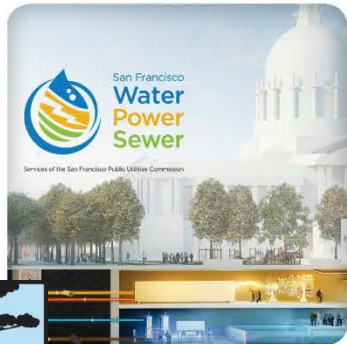

Civic Center Sustainable Utilities District Plan

Public Utilities Commission



Other Projects Underway

- Van Ness Bus Rapid Transit
- Better Market Street
- Grove Street Improvements
- Polk Street Bike Lanes
- Brooks Hall Reuse



 Design Focus Area



Existing Conditions

Margaret S. Hayward



Public Restroom & Clubhouse: significant renovation required for code compliance; Lacks picnic & gathering spaces.



Tennis courts very popular; in good condition.



Dept. of Emergency Management



Playground at busy corner, outdated.

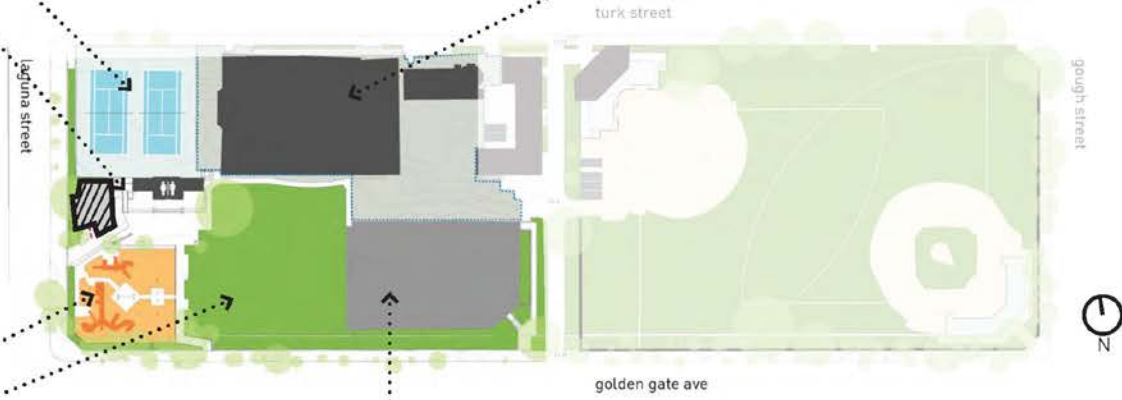

Multipurpose lawn is underutilized and in poor condition.



Sports courts are isolated.



Building Design & Construction

West-half Site Assessment + Challenges

Margaret Hayward Playground | Community Workshop #2 | 03.03.16

Deteriorating Buildings: (WACTC) Western Addition Computer Technology Center, Rec + Park Operations Facility.



Deteriorating Buildings: Fieldhouse & Storage.

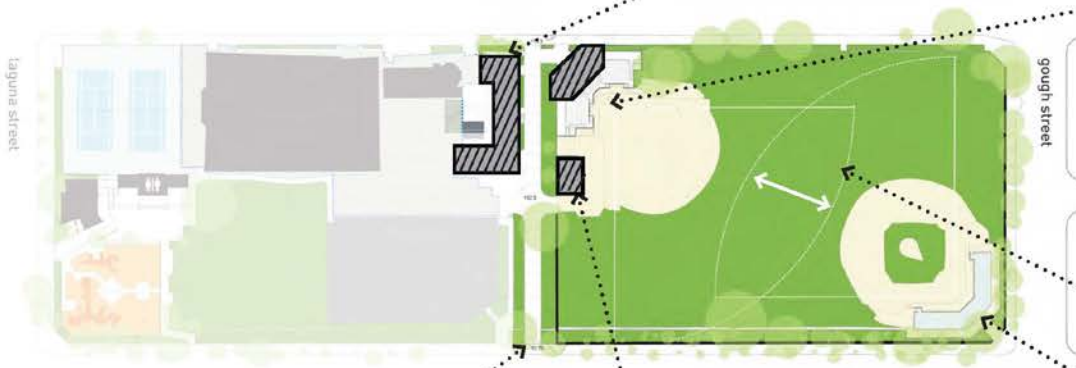

Overlap of outfields causes play interference; no ADA access to majority of field.



Driveway separates park into two halves and conflicts with pedestrian use.



Operations storage takes up valuable recreation space and is unsightly and poorly located.



Uninviting South East entrance and deteriorating bleachers.



- Create a unified and beautiful park.
- Activate the park by providing an integrated and connected park: remove barriers, improve circulation, and relocate activities and services as needed.
- Increase outdoor space by expanding the landscape and removing or consolidating structures.
- Improve park safety and security by improving sight lines and providing places for positive activity.
- Provide a park that encourages the use of the playground by neighborhood families and residents.
- Balance the uses of Margaret Hayward playground with the uses of Jefferson Square Park.













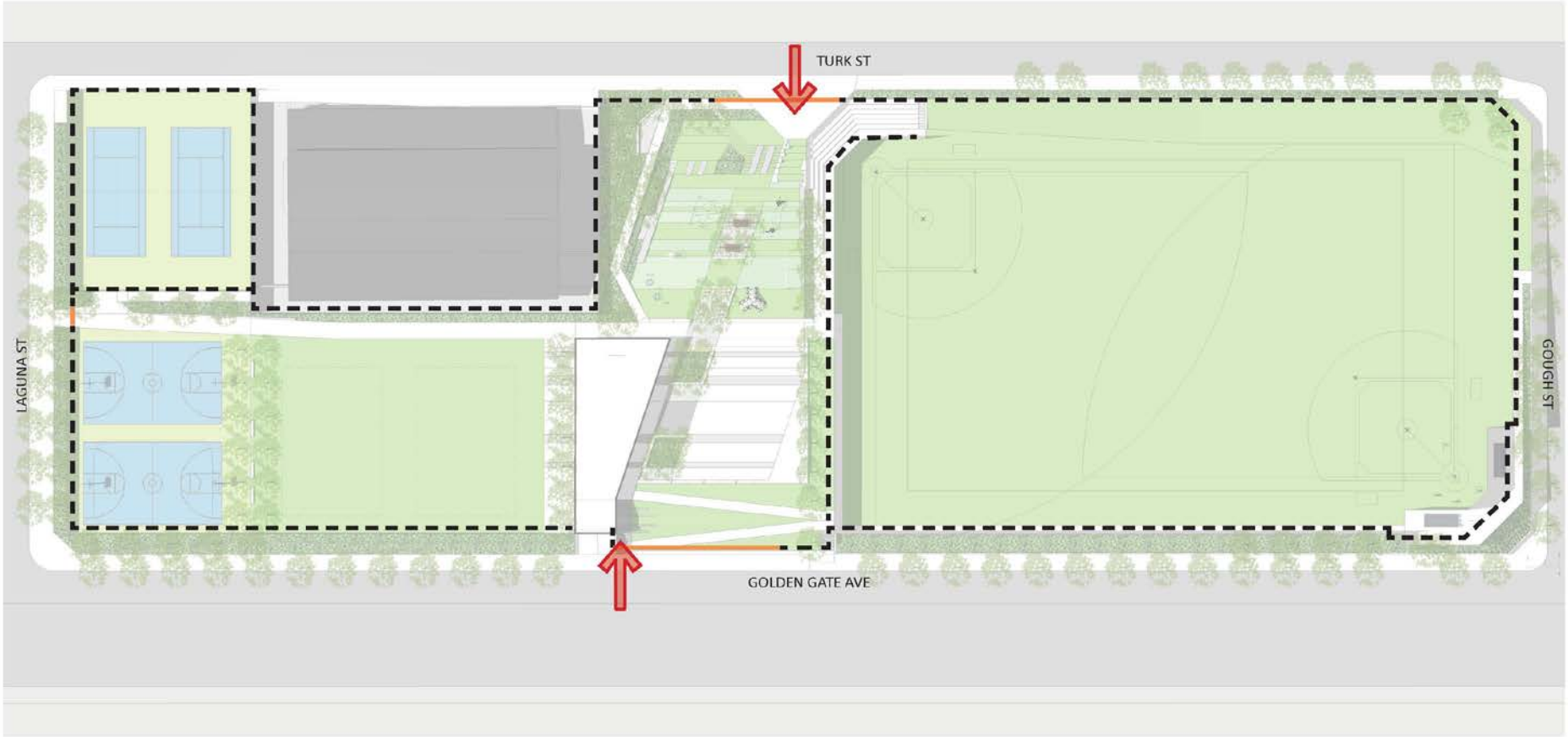

PARK
OPEN



PARK
CLOSED

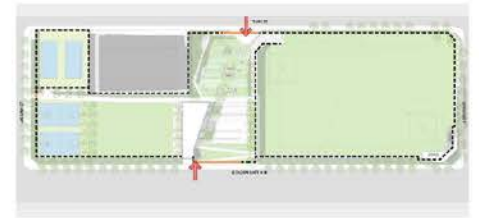

**CITY OF
PUBLIC
WORKS**

Building Design & Construction

Perimeter Fencing: Golden Gate Avenue Entrance
Margaret Hayward Playground | Community Workshop #4 | May 3, 2017

PARK
OPEN



PARK
CLOSED

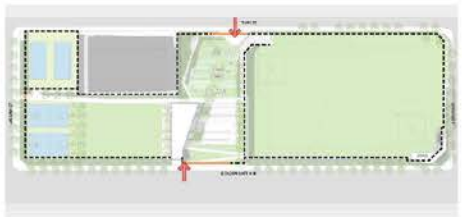
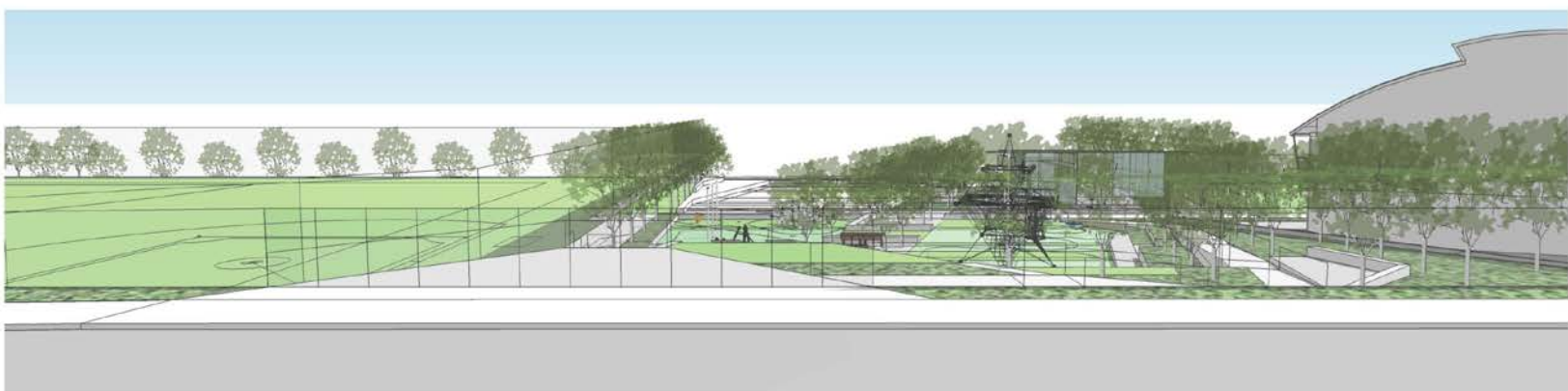









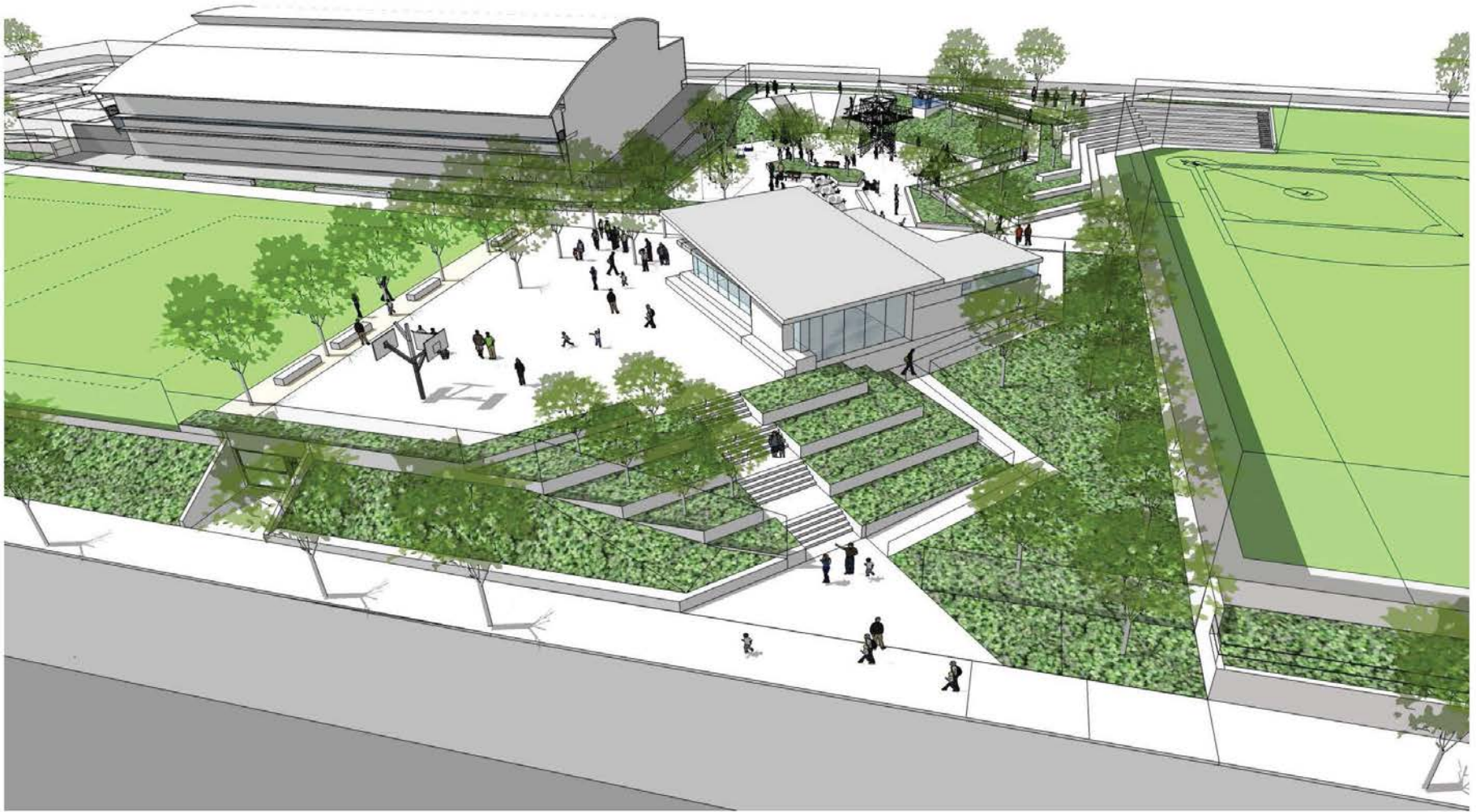







**PUBLIC
WORKS**

Building Design & Construction

Hedgerow: Perspective from GG Ave

Margaret Hayward Playground | Civic Design Review: Informal | August 15th, 2016



Planning

Spring 2016

Workshop #1 Review Site Assessment & Project Goals

January 2016

Workshop #2 Review Planning Options & Establish Preferred Approach

March 2016

Workshop #3 Finalized Design Approach & Community Room

May 2016

Workshop #4 Update on Design Development

May 2017

Design

Spring '17 - Spring '18

Bidding

Summer 2018

Construction

Fall 2018 - Winter 2019

