

MARKET OCTAVIA LIVING ALLEYS



Market Octavia CAC - Workshop 2 Preview | October 19, 2020



WORKSHOP 2

OBJECTIVE //

- *Program Update: Provide an update on the Living Alleys program, including budget and timeline for implementation*
- *W1 Report Back: Survey results, selection process*
- *Concept Designs: Obtain feedback on living alley design concepts*

WORKSHOP 2 AGENDA

PROGRAM INFORMATION //

WORKSHOP #1 REPORT-BACK //

CONCEPT DESIGNS //

NEXT STEPS //

LIVE POLLS, QUESTIONS,

SUGGESTIONS, STORIES //

Throughout the presentation, please share your questions, suggestions, and stories through the Q&A chat function. At the end of the presentation, a facilitator will respond to some of the most common questions

POWELL

Did you attend Workshop #1 in June?

An aerial photograph of a public square or plaza. In the center, a group of people is gathered, some standing and some sitting on a bench. The ground is paved with light-colored tiles. To the left, there's a concrete bench and a yellow tactile paving strip. The background shows a building with a tree in front of it. A large white rectangular box is overlaid on the center of the image, containing the text 'PROGRAM INFORMATION //'.

PROGRAM INFORMATION //

A LIVING ALLEY is a narrow, pedestrian-oriented street that is designed to focus on livability, instead of parking and traffic. Typically, this means creating a street primarily for pedestrians and bicyclists, as well as space for social uses. It can be considered an “urban living room”.



FUNDING AND IMPLEMENTATION

- **Living Alleys Program Transition //**

The Living Alleys Program is now under the direction of San Francisco Public Works who will provide the design and implementation of a community supported vision for living alley improvements within the Market Octavia Plan area

- **\$4M from Market Octavia Impact Fees //**

CAC approved allocation of these funds for Living Alleys public realm improvements

- **Full funding to come on line through Fiscal Year 2023-2024 //**

Funds are dependent on projected developments within the Market Octavia Area Plan and Market Octavia Plan Amendment boundaries and will be apportioned each fiscal year

IMPLEMENTATION TIMELINE

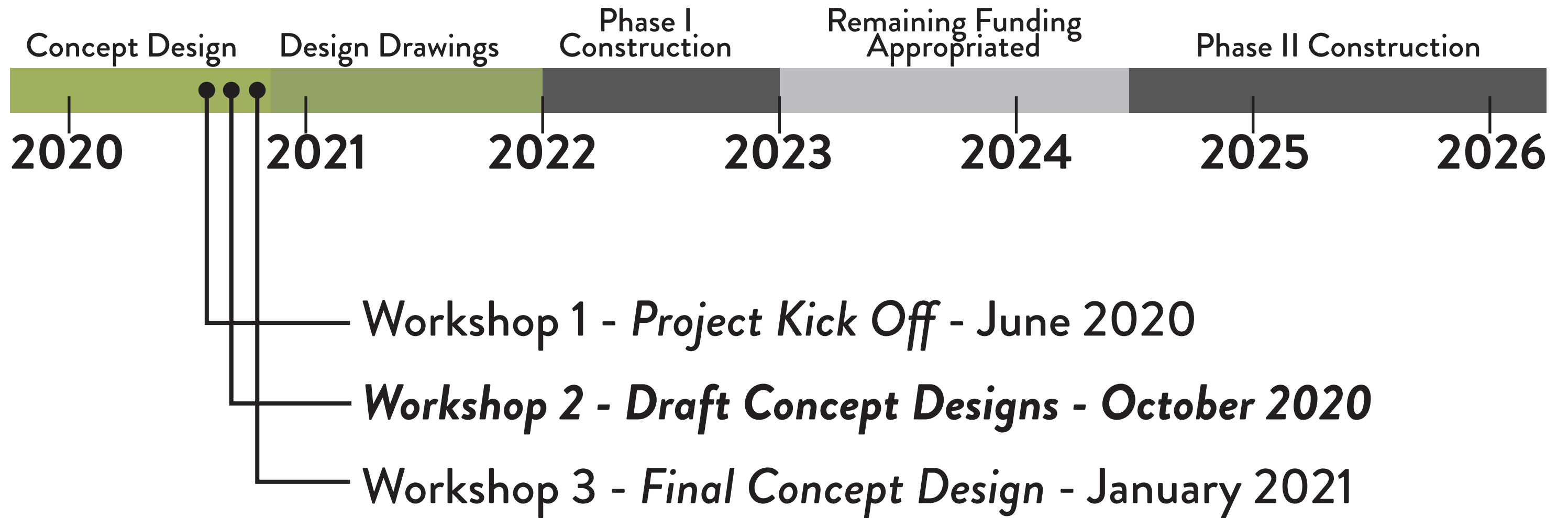

An aerial photograph of a public square or plaza. In the center, a group of about ten people are gathered, some standing and some sitting on a bench. The ground is paved with light-colored tiles and has a yellow tactile paving strip. There are trees and a building in the background. A large white rectangular box is overlaid on the center of the image, containing the text 'WORKSHOP 1 REPORT-BACK //'.

WORKSHOP 1 REPORT-BACK //

WORKSHOP 1 FEEDBACK

ALLEYS IDENTIFIED AS PRIORITY //



“PLEASE SELECT THE BALANCE OF IMPROVEMENTS YOU’D LIKE TO SEE” //

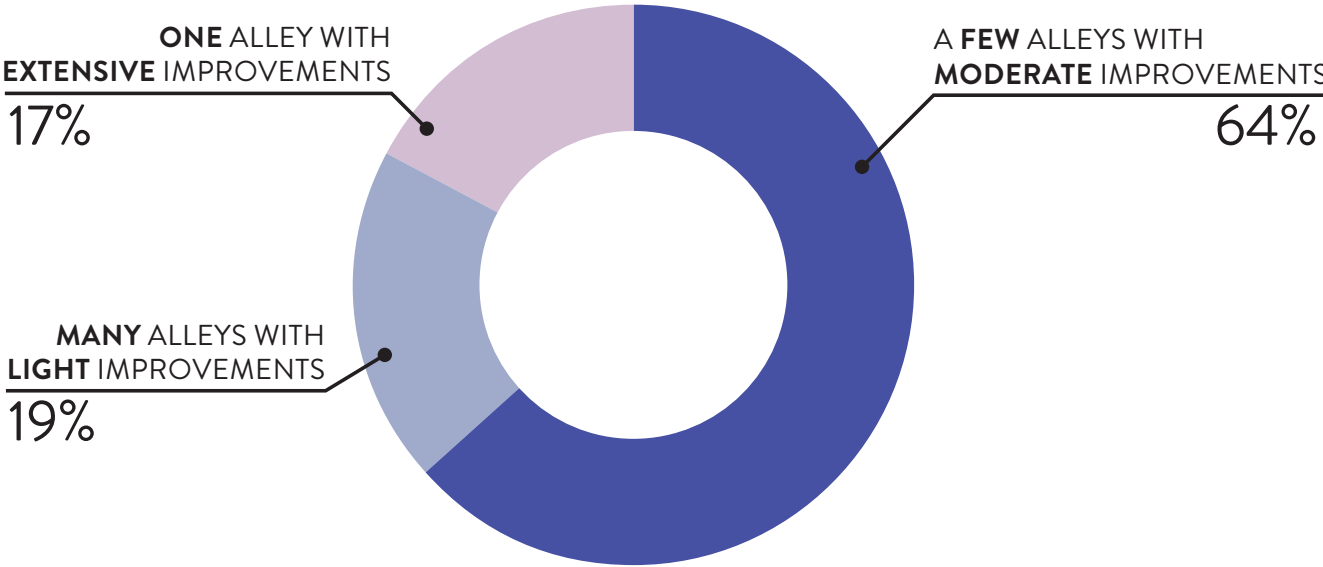

“PLEASE PICK YOUR TOP THREE ALLEY IMPROVEMENTS YOU’D LIKE TO SEE IMPLEMENTED” //

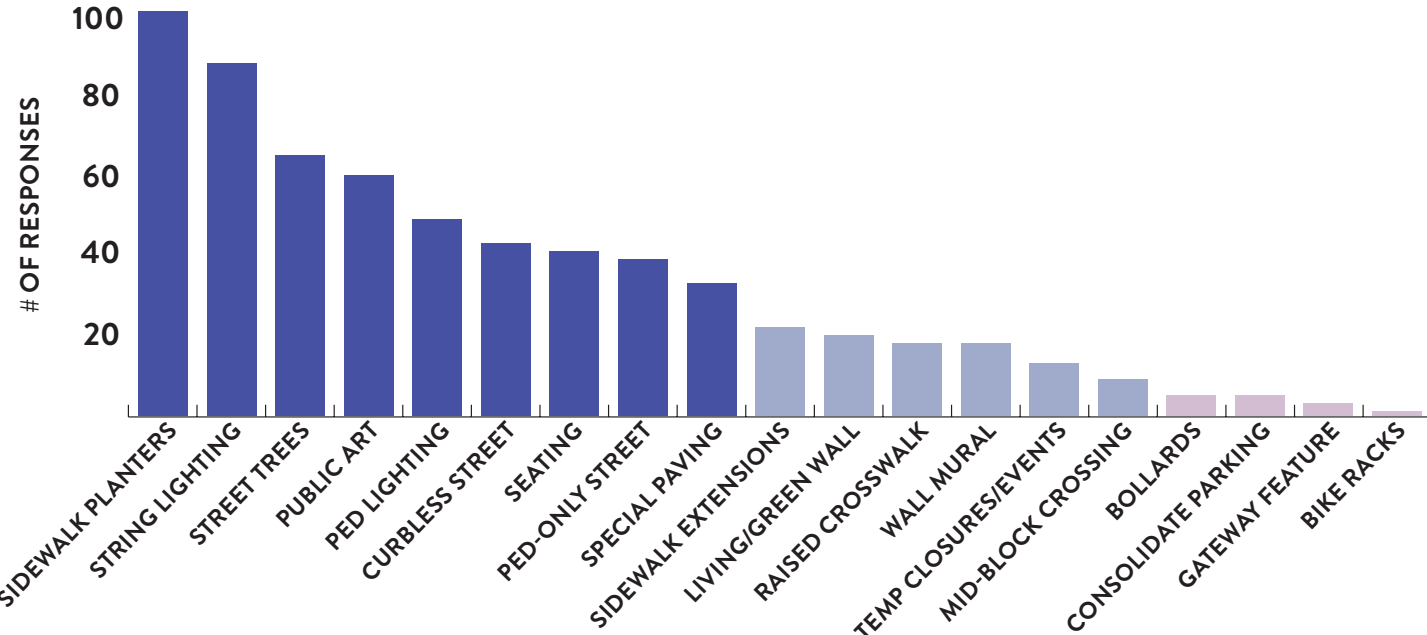

CRITERIA FOR ALLEY SELECTION

ALLEY	STAKEHOLDER INPUT	UPCOMING REPAVING	PCI SCORE	RECENTLY REPAVED	CURRENT DEV'T PROJECTS	GROUND FLOOR CONDITION	STEWARDSHIP & PROGRAMMING	EXISTING CONCEPT PLAN
Ivy (Laguna to Octavia)	42		Excellent	Y		Residential, garages, retail end at Octavia	LagunaHayes HOA	
Brady (Market to Otis)	36		Excellent		1629 Market	Residential, office, retail	Mazzola Gardens	Y Hub
Woodward (Duboce to 14th)	31		Good			Residential, garages		
Stevenson (Duboce to McCoppin)	28		Excellent			Sk8 park, dog park, residential		Y Hub
Rosemont (at 14th)	22		Excellent			Residential, mainly garages		
Ivy (Octavia to Gough)	21		Excellent	Y		Gough end retail, residential walk up and garages		
Colton (Gough to Colusa)	19		Excellent	Y	1629 Market	parking, blank facades Gough to Brady, office	Mazzola Gardens	Y Hub
Elgin Park (McCoppin to Duboce)	17		Excellent			Residential, garages		
Ramona (14th to 15th)	17		Excellent			Residential, garages		
Minna (Lafayette to 11th)	15		Excellent			Residential, live-work, PDR		Y Hub
Lafayette (Mission to Howard)	14		Good / Excellent			Residential, retail ends		Y Hub
Stevenson (Gough to Brady)	12		Excellent		1629 Market	Residential, parking, blank façade, retail	Mazzola Gardens	Y Hub
Stevenson (14th to Clinton Park)	11		Good			blank facades		
Rose (Gough to Market)	11		Excellent			Back of house of retail	Belden type activation with surrounding restaurants	Y Hub
Lily (Octavia to Gough)	9		Excellent	Y		Residential, garages		
Clinton Park (Dolores to Guerrero)	8		Good			Residential, garages		
Linden (Octavia to Laguna)	8		Excellent			Residential, garages, retail end at Laguna		
Lily (Gough to Franklin)	7		Excellent		98 Franklin	Residential, garages, school	International high school?	Y Hub
Lily (Laguna to Octavia)	5	Y	Poor			Residential, garages		
Linden (Gough to Franklin)	5		Excellent	Y		Residential, garages, back of house for retail, sf jazz	SF Jazz?	

COORDINATED EFFORTS - BRADY BLOCK

GOULD EVANS - BRADY STREET OUTREACH MAY 2019

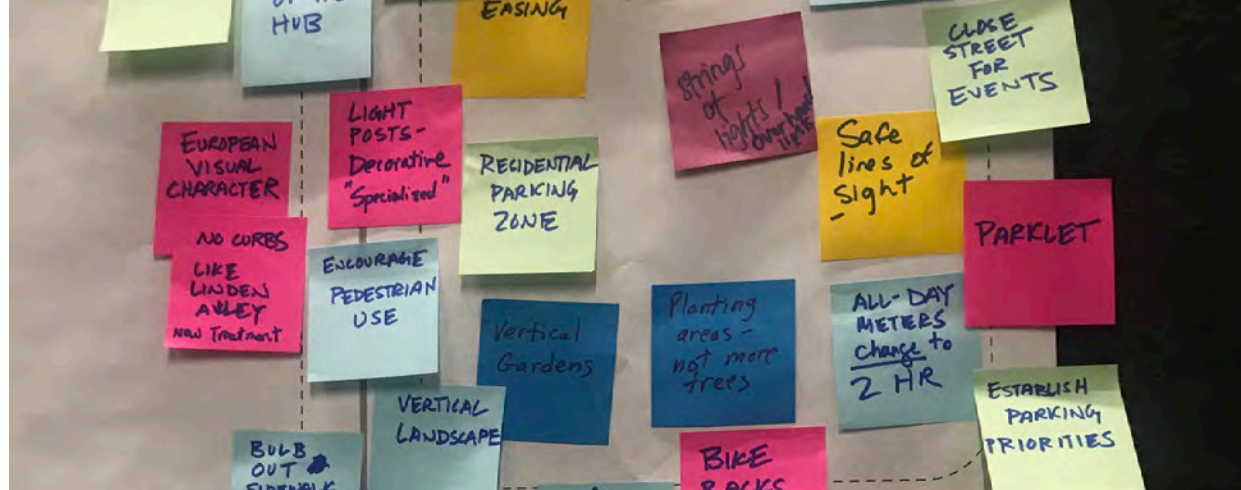

<p>How do you get around the neighborhood?</p> <p>Walk <input type="radio"/> <input type="radio"/> <input type="radio"/> <input type="radio"/> <input type="radio"/></p> <p>Bike <input type="radio"/> <input type="radio"/> <input type="radio"/> <input type="radio"/> <input type="radio"/></p> <p>Drive <input type="radio"/> <input type="radio"/> <input type="radio"/> <input type="radio"/> <input type="radio"/></p> <p>Public Transit <input type="radio"/> <input type="radio"/> <input type="radio"/> <input type="radio"/> <input type="radio"/></p>	<p>If you own a car, do you park your car on the street?</p> <p>Always <input type="radio"/> <input type="radio"/> <input type="radio"/> <input type="radio"/> <input type="radio"/></p> <p>Sometimes <input type="radio"/> <input type="radio"/> <input type="radio"/> <input type="radio"/> <input type="radio"/></p> <p>Never <input type="radio"/> <input type="radio"/> <input type="radio"/> <input type="radio"/> <input type="radio"/></p> <p>Other <input type="radio"/> <input type="radio"/> <input type="radio"/> <input type="radio"/> <input type="radio"/></p>
<p>What do you think about the vehicular traffic conditions along Brady Street?</p> <p>All survey respondents answered "Traffic is fine."</p>	<p>Which of the following types of street space events do you attend?</p> <p>Street fair or festival <input type="radio"/> <input type="radio"/> <input type="radio"/> <input type="radio"/> <input type="radio"/></p> <p>Farmer's market <input type="radio"/> <input type="radio"/> <input type="radio"/> <input type="radio"/> <input type="radio"/></p> <p>Music festival <input type="radio"/> <input type="radio"/> <input type="radio"/> <input type="radio"/> <input type="radio"/></p> <p>March or protest <input type="radio"/> <input type="radio"/> <input type="radio"/> <input type="radio"/> <input type="radio"/></p> <p>Other <input type="radio"/> <input type="radio"/> <input type="radio"/> <input type="radio"/> <input type="radio"/></p>
<p>Please rate the quality of the street lighting along Brady.</p> <p>Low quality <input type="radio"/> <input type="radio"/> <input type="radio"/> <input type="radio"/> <input type="radio"/> <input type="radio"/> <input type="radio"/> <input type="radio"/></p> <p>Neither high nor low quality <input type="radio"/> <input type="radio"/> <input type="radio"/> <input type="radio"/> <input type="radio"/> <input type="radio"/> <input type="radio"/> <input type="radio"/></p>	

STRADA - 1629 MARKET DEVELOPMENT UNDER CONSTRUCTION (INITIAL CONCEPT PLAN SHOWN BELOW)



COMPLETED LIVING ALLEYS

EXISTING LIVING ALLEYS AS INSPIRATION

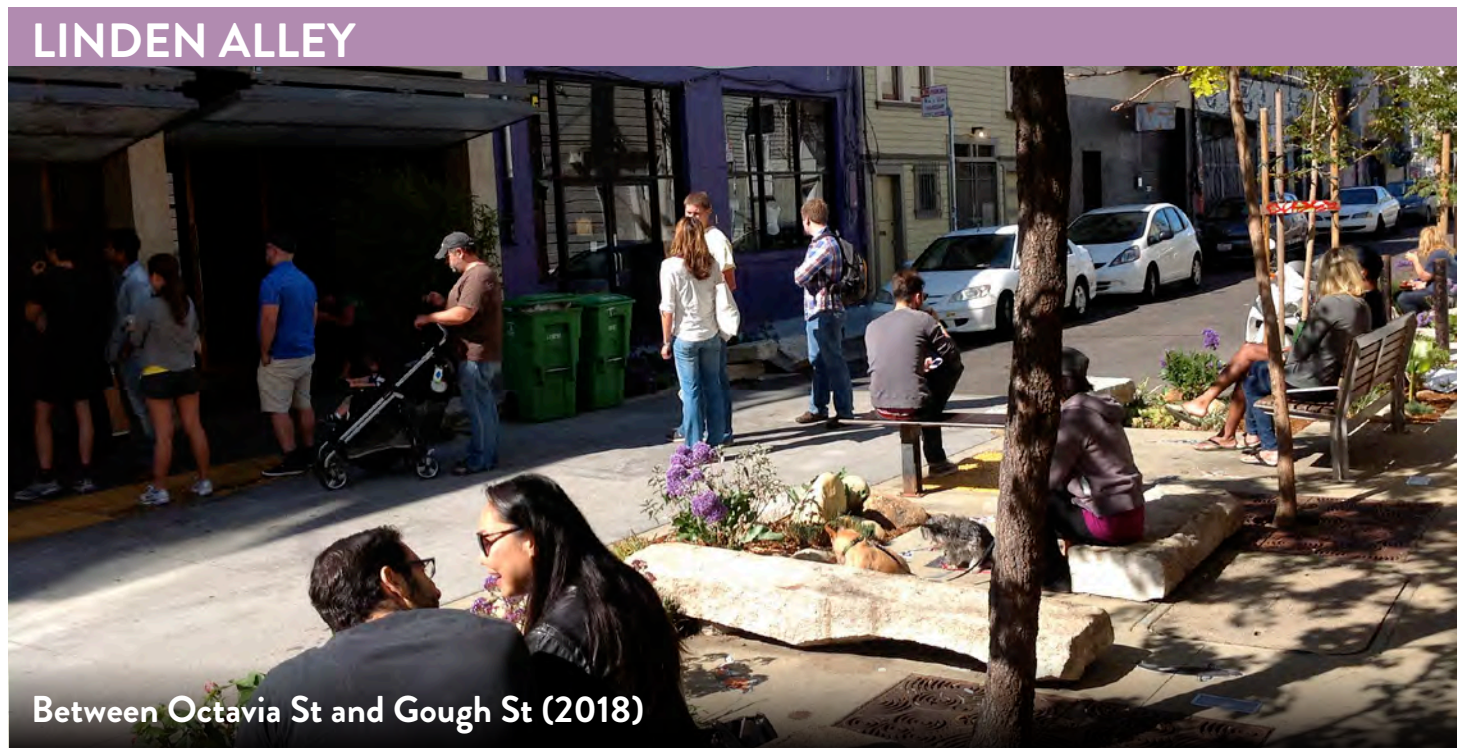

An aerial photograph of a public square or plaza. In the foreground, a group of people is gathered, some standing and some sitting on a bench. The ground is paved with light-colored tiles and features a yellow tactile paving strip. A large, white, semi-transparent rectangular box is overlaid on the center of the image, containing the text "CONCEPT DESIGNS //". The background shows a building with a tree and a paved area with a yellow stripe.

CONCEPT DESIGNS //

BRADY STREET // CONCEPT DESIGN

Market to Otis



BRADY STREET // CONCEPT DESIGN

Market to Otis - a calm, safe, and green neighborhood connector

CONCEPT A // Sidewalk Paver Strip

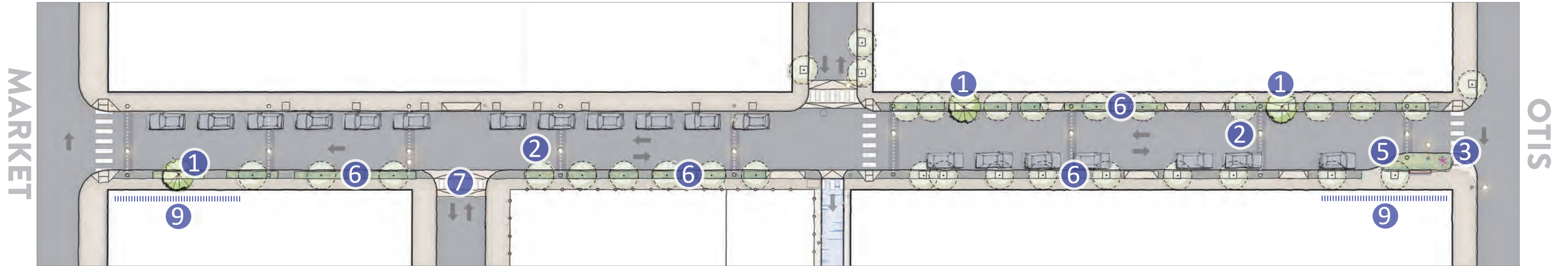

CONCEPT B // Raised Intersection

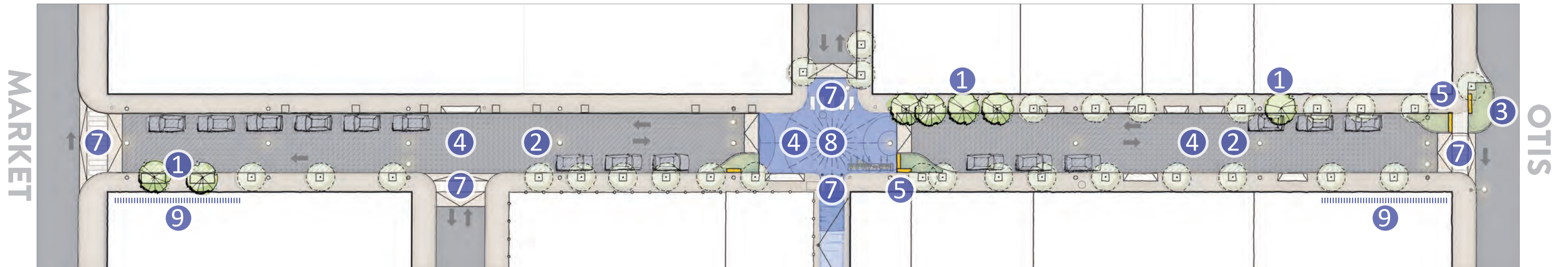

1 INFILL TREE PLANTING

2 PED-SCALE LIGHTING

3 CORNER PLANTER

4 DECORATIVE PAVING

5 SEATWALL

6 SIDEWALK PAVER STRIP

7 RAISED CROSSING

8 RAISED INTERSECTION

9 POTENTIAL MURAL OPPORTUNITY

BRADY STREET // CONCEPT DESIGN

Market to Otis

CONCEPT A // Sidewalk Paver Strip

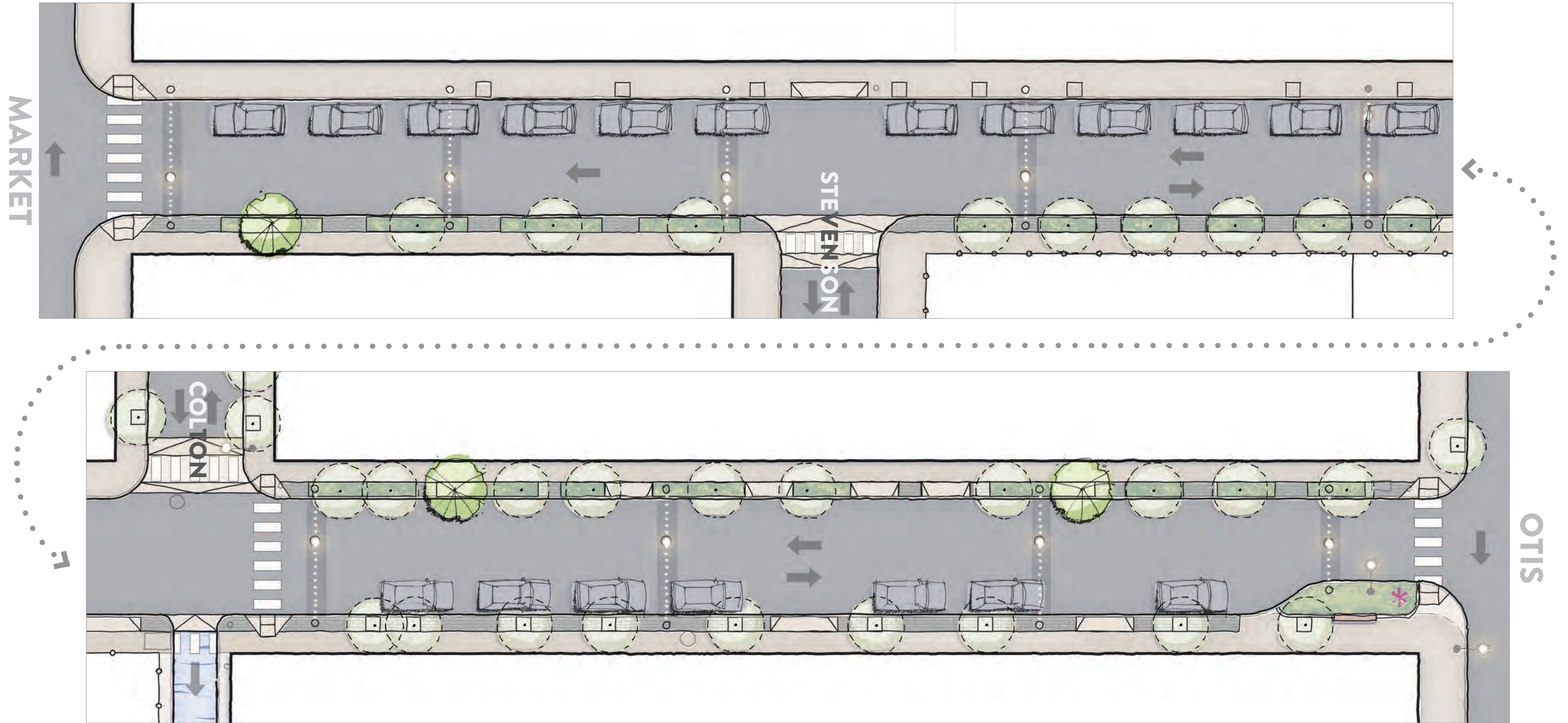

BRADY STREET // CONCEPT DESIGN

Market to Otis

CONCEPT B // Raised Intersection

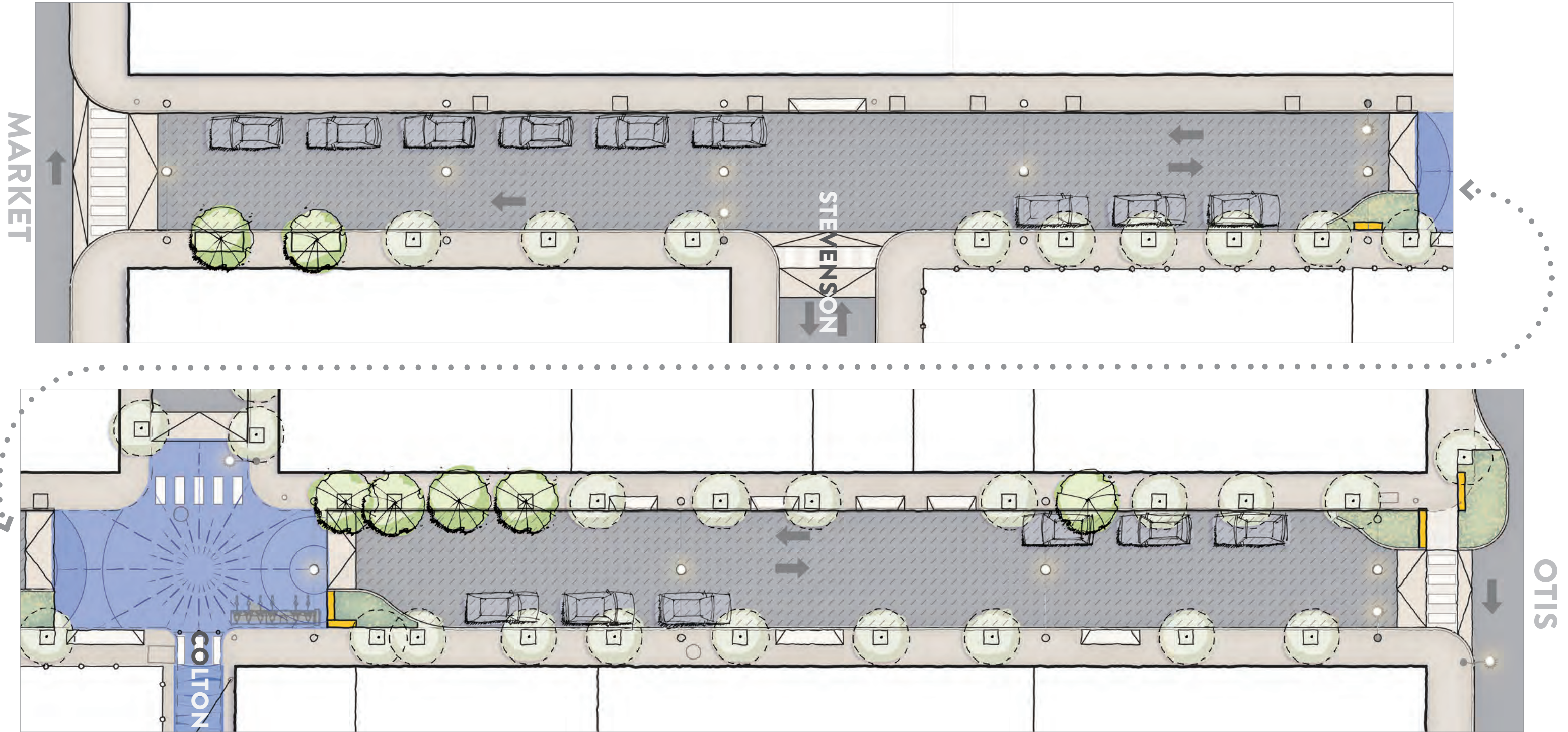

BRADY STREET // INSPIRATION

Market to Otis



1 INFILL TREE PLANTING



2 PED-SCALE LIGHTING



3 CORNER PLANTER



4 DECORATIVE PAVING



5 SEATWALL



6 SIDEWALK PAVER STRIP



7 RAISED CROSSING



8 RAISED INTERSECTION

POLL

Which design concept do you prefer for
BRADY STREET: A, or B?

COLTON STREET // CONCEPT DESIGN

Brady to Gough



COLTON STREET // CONCEPT DESIGN

Brady to Gough - a programmable, pedestrian-oriented link to Brady Block's public space amenities

CONCEPT A // Shared Street

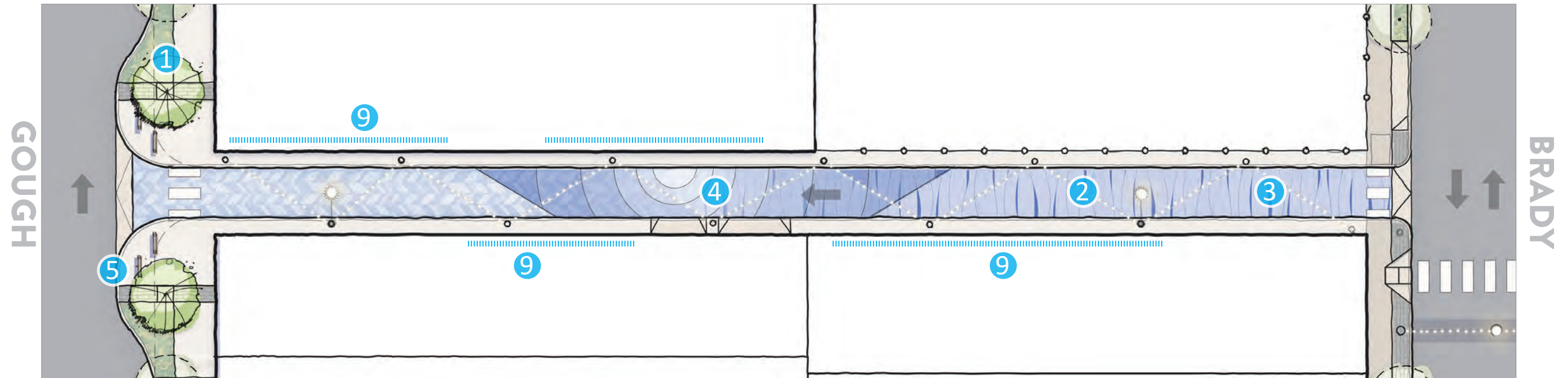

CONCEPT B // Partial Pedestrian-Only Street

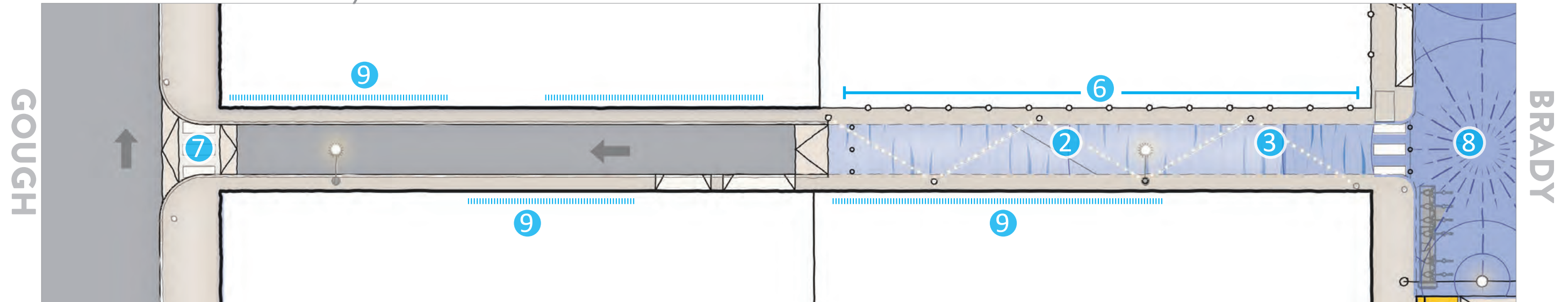

1 INFILL TREE PLANTING

2 PED-SCALE LIGHTING

3 DECORATIVE PAVING

4 SHARED STREET

5 CORNER SIDEWALK EXTENSION

6 PEDESTRIAN-ONLY STREET

7 RAISED CROSSING

8 RAISED INTERSECTION

9 POTENTIAL MURAL OPPORTUNITY

COLTON STREET // INSPIRATION

Brady to Gough



1 INFILL TREE PLANTING



2 PED-SCALE LIGHTING



3 DECORATIVE PAVING



4 SHARED STREET



5 CORNER SIDEWALK EXT.



6 PEDESTRIAN-ONLY STREET



7 RAISED CROSSING



8 RAISED INTERSECTION

POLL

Which design concept do you prefer for
COLTON STREET: A, or B?

IVY STREET // CONCEPT DESIGN

Laguna to Octavia



LEGEND

- Alleys selected for Living Alley improvements
- Alleys identified in survey as priorities
- Completed Living Alleys
- Hub Area
- Market Octavia Area
- Green/Open Space



IVY STREET // CONCEPT DESIGN

Laguna to Octavia - a calm and safe neighborhood 'front porch' for interaction and activities

CONCEPT A // Corner Plaza

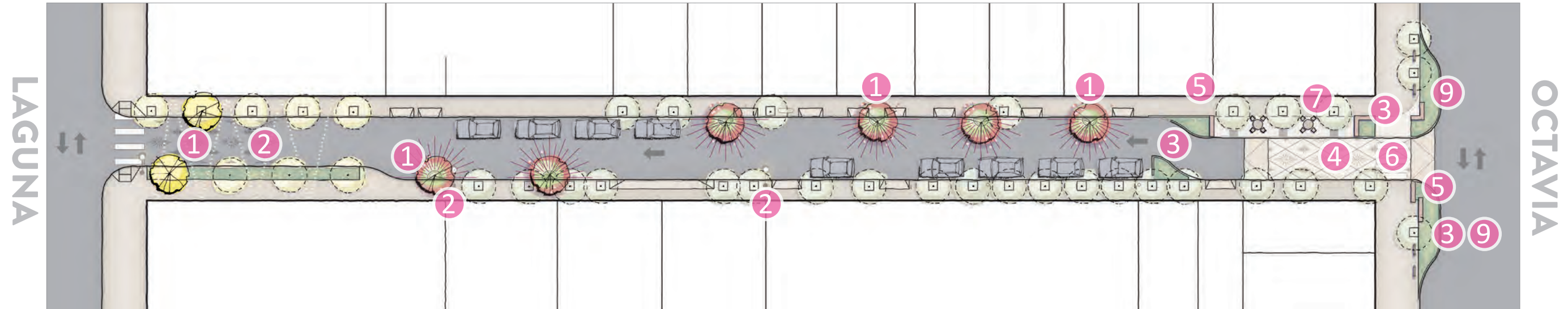

CONCEPT B // Living Zone

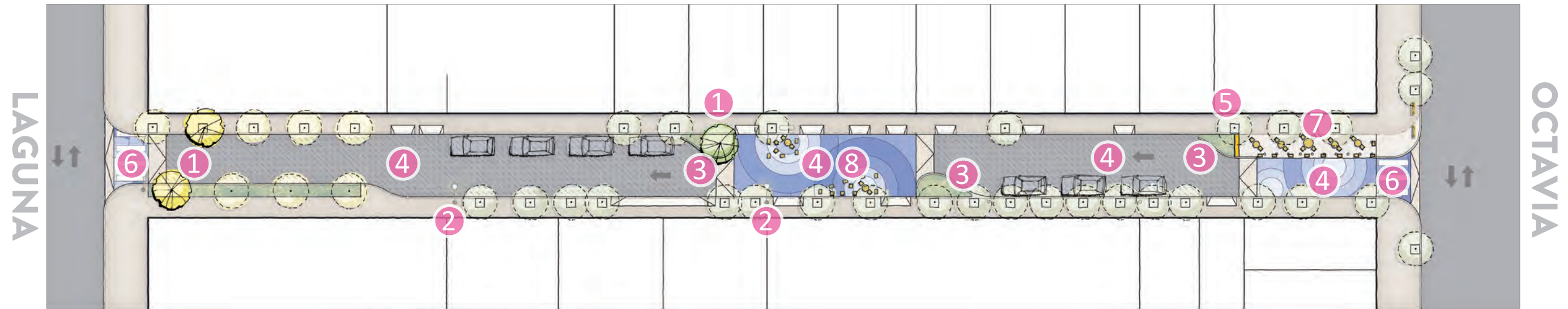

1 INFILL TREE PLANTING

2 PED-SCALE LIGHTING

3 PLANTER

4 DECORATIVE PAVING

5 SEATWALL

6 RAISED CROSSING

7 CORNER PLAZA

8 RAISED 'LIVING ZONE'

9 CORNER EXTENSIONS

IVY STREET // CONCEPT DESIGN

Laguna to Octavia

CONCEPT A // Corner Plaza

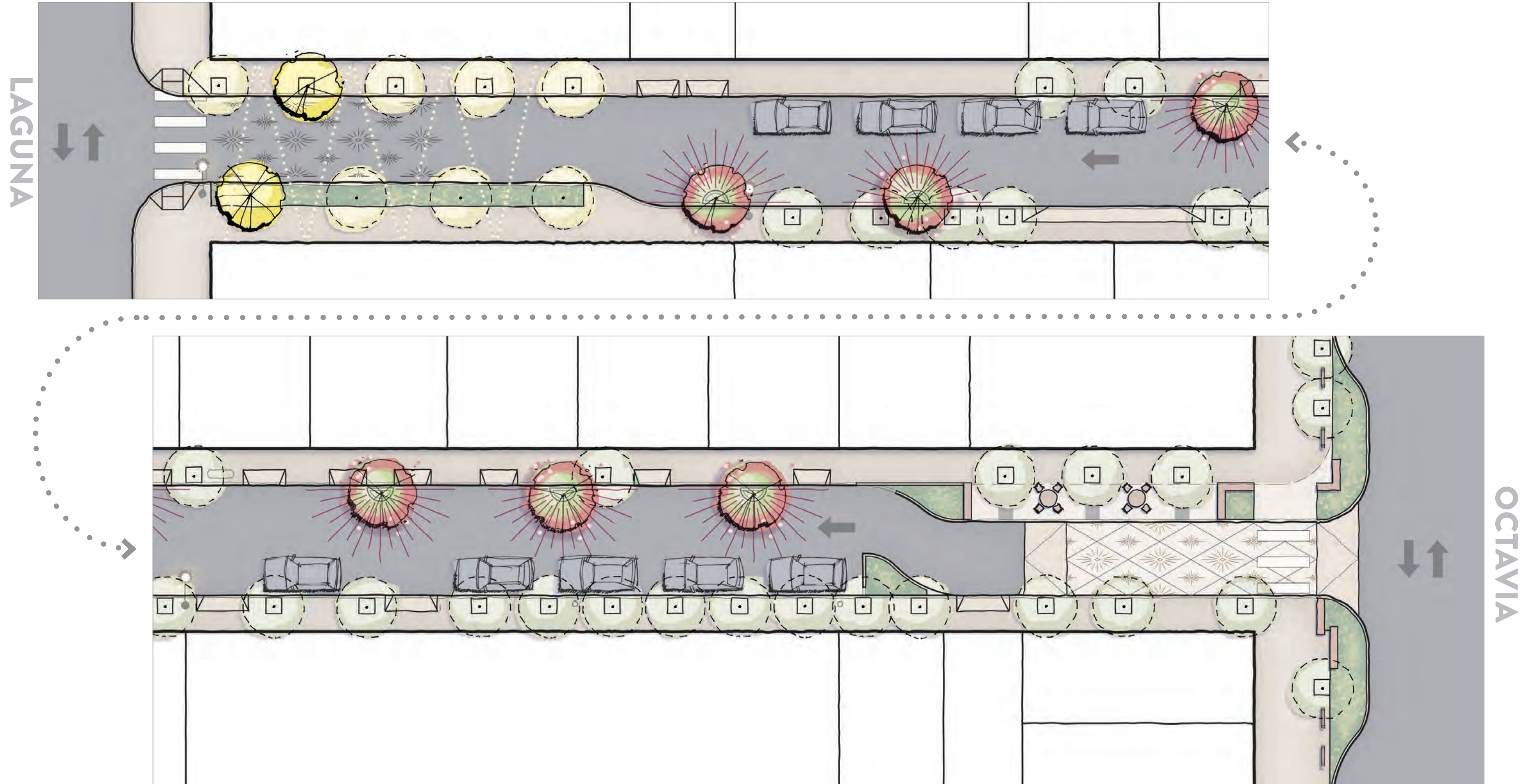

IVY STREET // CONCEPT DESIGN

Laguna to Octavia

CONCEPT A // Corner Cafe

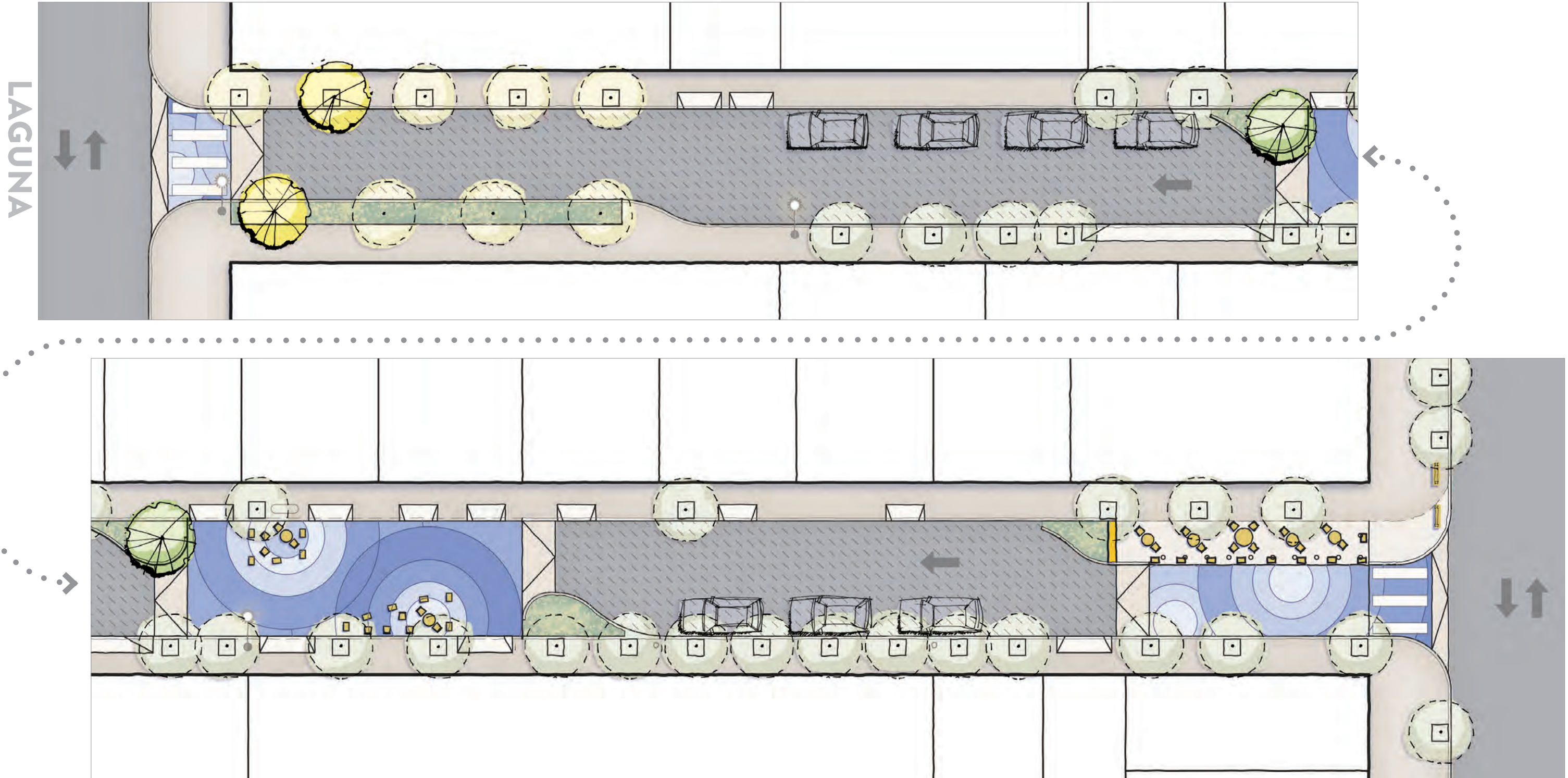

IVY STREET // INSPIRATION

Laguna to Octavia



1 INFILL TREE PLANTING



2 PED-SCALE LIGHTING



3 PLANTER



4 DECORATIVE PAVING



5 SEATWALL



6 RAISED CROSSING



7 CORNER PLAZA



8 RAISED 'LIVING ZONE'

POLL

Which design concept do you prefer for
IVY STREET: A, or B?

COMMUNITY-LED IMPROVEMENTS // PRIVATE PARTNERSHIPS

ALTERNATIVE LIGHTING



FACADE TREATMENTS

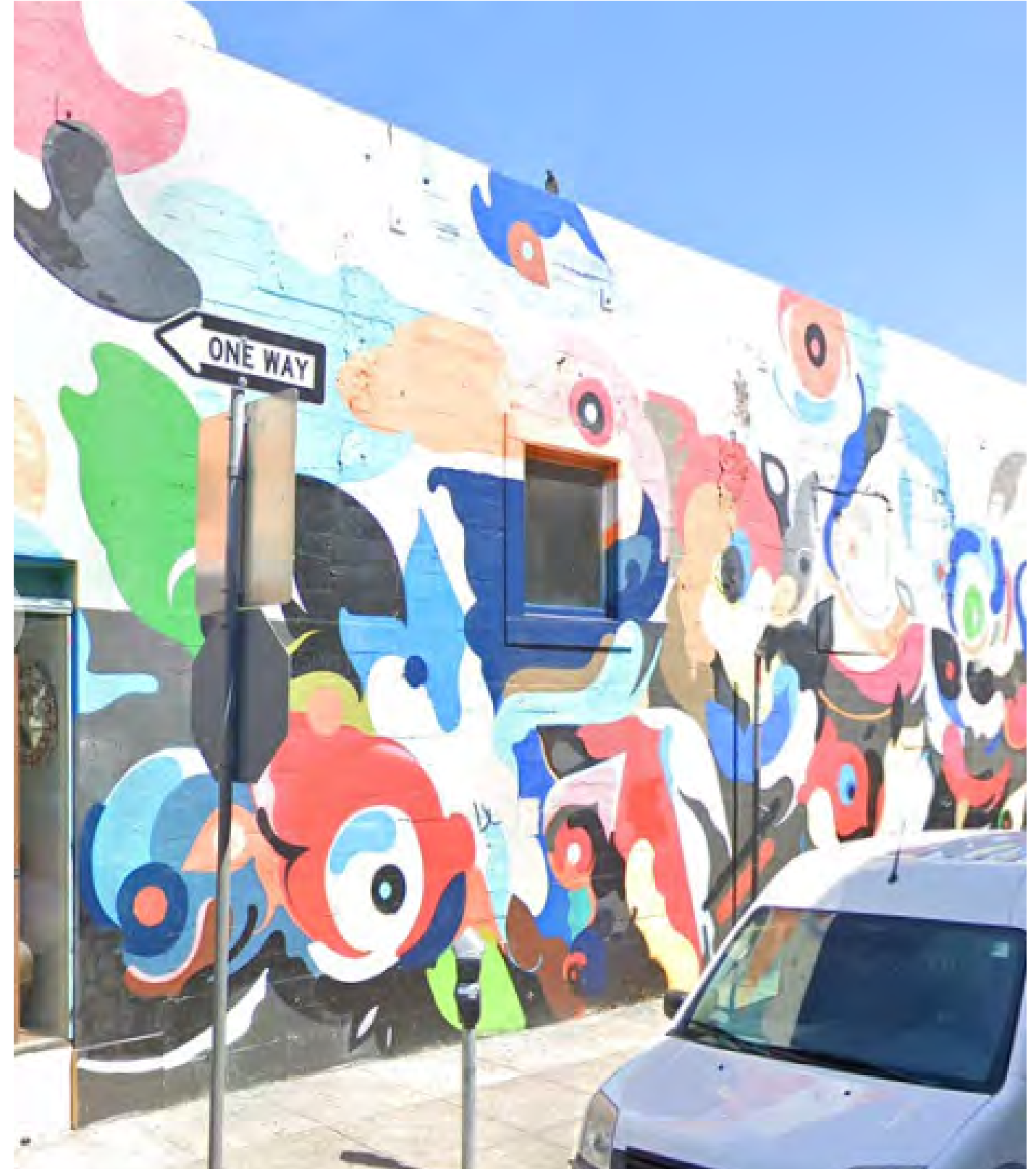

An aerial photograph of a public square or plaza. In the center, a group of about ten people are gathered, some standing and some sitting on a bench. The ground is paved with light-colored tiles. To the left, there's a concrete bench and a yellow tactile paving strip. A large white rectangular box is overlaid on the top half of the image, containing the text 'NEXT STEPS //'. The background shows a building with a tree and a street with a yellow curb.

NEXT STEPS //

NEXT STEPS

FEEDBACK //

We need your help selecting a preferred design.

Take our online survey!

sfpublicworks.org/living-alleys

UPCOMING OUTREACH //

Workshop 3 - Final Concept Design

January 2021

On-Site Discussions

November 2020

ON-SITE DISCUSSION //

*We'll be out in the alleys discussing the concept designs. Please stop by!**

--SATURDAY--

NOVEMBER 14, 2020

10-11 AM

Brady Street at Colton

12-1 PM

Ivy Street between Octavia and Laguna

** In accordance with the latest SFPD Health Guidelines and Directives, face masks are required at all times as is social distancing of at least 6' between individuals. Thank you for your cooperation.*

For more information on the latest health guidelines, please visit sfdph.org

THANK YOU!

MARKET OCTAVIA
LIVING ALLEYS

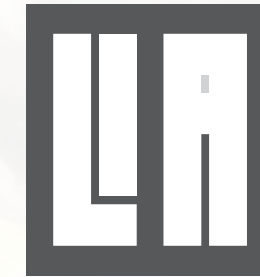

sfpublicworks.org/living-alleys

Let us hear from you!

Contact Information

Arun Bhatia, Project Manager

arun.bhatia@sfdpw.org | (415) 987-4872

Survey QR Code

